

TDS

Open Frame 32"/42"/43"/55"



Remote key with 1.5 meter cable
(option)



Force touch

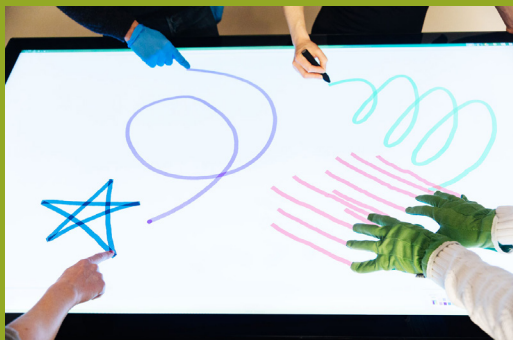

Use with glove
or stylus

Landscape or portrait or table

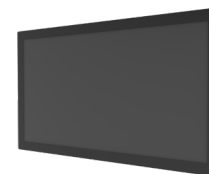

TDS-32

TDS-32 Lite

TDS-42-IGR

TDS-43

Size	31.5" TFT LCD	31.5" TFT LCD	42" TFT LCD	43" TFT LCD
Maximum Resolution	1920 x 1080	1920 x 1080	1920 x 1080	1920 x 1080
Contrast Ratio	3000:1	3000:1	4000:1	1100:1
Brightness	500 nits (No Touch), 450 nits (P-CAP)	350 nits (No Touch), 315 nits (P-CAP)	500 nits (No Touch), 445 nits (In Glass IR)	450 nits (No Touch), 351 nits (P-CAP)
View Angle	H:178°, V:178°	H:178°, V:178°	H:178°, V:178°	H:178°, V:178°
Touch LCD Display				
Touch Screen	Projected Capacitive	Projected Capacitive	In Glass IR with Force Touch	Projected Capacitive
Touch Points	10	10	10	10
Touch Screen Interface	USB-HID (Type B)	USB-HID (Type B)	USB-HID (Type B)	USB-HID (Type B)
IO ports				
Serial Port	COM1 (Input), COM2 (Output), 1 x RJ11 (for Remote Key)	-	COM1 (Input), COM2 (Output), 1 x RJ11 (for Remote Key)	1 x RJ11 (for Remote Key)
USB Port	1 x USB 2.0 (Type B) for Touch Interface (USB-HID)	1 x USB 2.0 (Type B) for Touch Interface (USB-HID)	1 x USB 2.0 (Type B) for Touch Interface (USB-HID)	1 x USB 2.0 (Type B) for Touch Interface (USB-HID)
Video Port	1 x VGA, 1 x DVI	1 x VGA, 1 x DVI, 1 x HDMI	1 x VGA, 1 x HDMI, 1 x DP	1 x VGA, 1 x HDMI, 1 x DP, 1 x DVI
Audio Port	1 x Line-in, 1 x Line-out	-	1 x Line-in, 1 x Line-out	1 x Line-in
Power Input	1 x AC Inlet	1 x AC Inlet	1 x AC Inlet	1 x AC Inlet
Physical Properties				
Power Supply	AC Input 100~240Vac, 50/60Hz	AC Input 100~240Vac, 50/60Hz	AC Input 100~240Vac, 50/60Hz	AC Input 100~240Vac, 50/60Hz
Speaker	2 x 10W	-	2 x 10W	2 x 12W
Housing Color	Black	Black	Black	Black
Construction	Glass, SECC Metal	Glass, SECC Metal	Glass, SECC Metal	Glass, AL, Plastic (ABS)
Compliance	Rear IPX1	Front Panel IP65 Compliant	Rear IPX1	-
Dimensions (W x H x D) mm	781.5 x 476.1 x 69.7	781.5 x 476.6 x 66.8	1022.2 x 616 x 74.4	983.2 x 571.4 x 80.7
Net Weight (kg)	16.8	13.4	24.8	19.5
Gross Weight (kg)	18.5	15.8	28.3	25.0
Carton (W x H x D) mm	945 x 650 x 185	945 x 650 x 185	1170 x 745 x 200	1170 x 745 x 200
VESA	400 x 200 mm	400 x 200 mm	400 x 200 mm	400 x 400 mm
Safety				
Certifications	CE, FCC, UL, cUL, RCM, TUV, BSMI, RoHS	CE(B), cUL, UL, CCC, RoHS	CE, FCC, UL, cUL, RCM, RoHS	CE(B), FCC(B), CCC, cUL, RoHS
Environment				
Operating Temperature	0°C ~ 40°C, 20% ~ 80% RH. Non-Condensing	0°C ~ 40°C, 20% ~ 80% RH. Non-Condensing	0°C ~ 40°C, 20% ~ 80% RH. Non-Condensing	0°C ~ 40°C, 20% ~ 80% RH. Non-Condensing
Storage Temperature	-20°C ~ 60°C, 10% ~ 90% RH. Non-Condensing	-20°C ~ 60°C, 10% ~ 90% RH. Non-Condensing	-20°C ~ 60°C, 10% ~ 95% RH. Non-Condensing	-20°C ~ 60°C, 10% ~ 95% RH. Non-Condensing
Optional Peripheral				
Remote Key	1.5 meter RJ11 Cable, Controls: Power, Select, Up, Down, Menu	-	1.5 meter RJ11 Cable, Controls: Power, Select, Up, Down, Menu	1.5 meter RJ11 Cable, Controls: Power, Select, Up, Down, Menu



TDS-55-IGR



TDS-55

Size	55" TFT LCD	55" TFT LCD
Maximum Resolution	3840 x 2160	3840 x 2160
Contrast Ratio	4000:1	1100:1
Brightness	450 nits (No Touch), 400 nits (In Glass IR)	500 nits (No Touch), 425 nits (P-CAP)
View Angle	H:178°, V:178°	H:178°, V:178°

Touch LCD Display

Touch Screen	In Glass IR with Force Touch	Projected Capacitive
Touch Points	10	10
Touch Screen Interface	USD-HID (Type B)	USB-HID (Type B)

IO ports

Serial Port	1 x RJ11 (for Remote Key)	1 x RJ11 (for Remote Key)
USB Port	1 x USB 2.0 (Type B) for Touch Interface (USB-HID)	1 x USB 2.0 (Type B) for Touch Interface (USB-HID)
Video Port	1 x VGA, 1 x DVI, 2 x HDMI, 2 x DP	1 x DVI-I, 2 x HDMI, 1 x DP
Audio Port	1 x Line-in, 1 x Line-out	1 x Line-in, 1 x Line-out
Power Input	1 x AC Inlet	1 x AC Inlet

Physical Properties

Power Supply	AC Input 100~240Vac, 50/60Hz	AC Input 100~240Vac, 50/60Hz
Speaker	2 x 12W	2 x 12W
Housing Color	Black	Black
Construction	Glass, SECC Metal	Glass, AL, Plastic (ABS)
Compliance	Rear IPX1	-
Dimensions (W x H x D) mm	1302.8 x 773.6 x 79	1247.6 x 732.4 x 78.8
Net Weight (kg)	44.5	44.5
Gross Weight (kg)	53.0	47.5
Carton (W x H x D) mm	1455 x 923 x 230	1455 x 923 x 230
VESA	400 x 400 mm	400 x 400 mm

Safety

Certifications	CE, FCC, RCM, RoHS	CE(B), FCC(B), CCC, cUL, RoHS
----------------	--------------------	-------------------------------

Environment

Operating Temperature	0°C ~ 40°C, RH. Non-Condensing	0°C ~ 40°C, RH. Non-Condensing
Storage Temperature	-20°C ~ 80°C, RH. Non-Condensing	-20°C ~ 80°C, RH. Non-Condensing

Optional Peripheral

Remote Key	1.5 meter RJ11 Cable, Controls: Power, Select, Up, Down, Menu	1.5 meter RJ11 Cable, Controls: Power, Select, Up, Down, Menu
------------	---	---

TDS-32

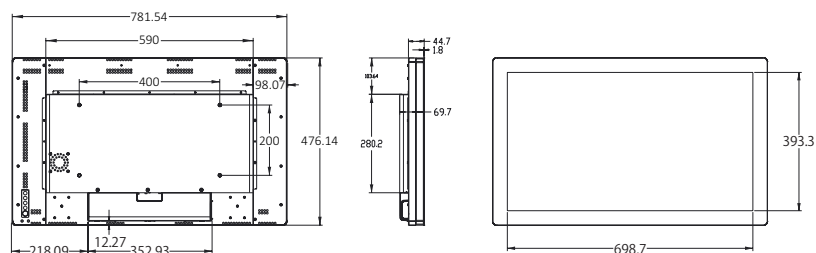
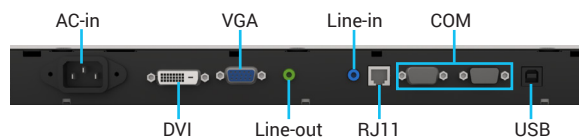

TDS-42-IGR

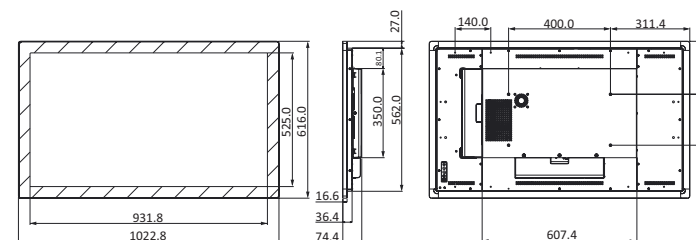
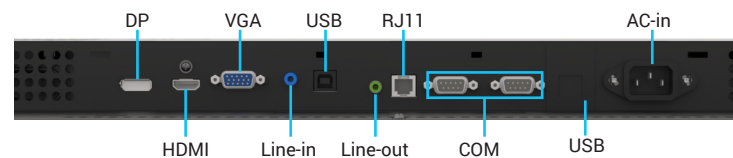

TDS-32 Lite

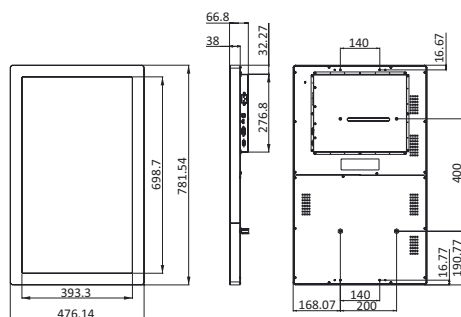
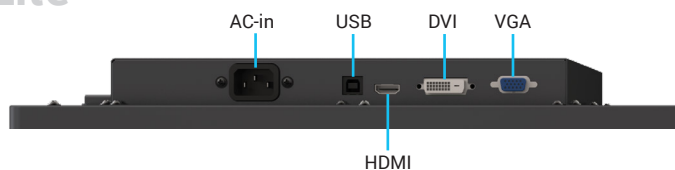

TDS-43

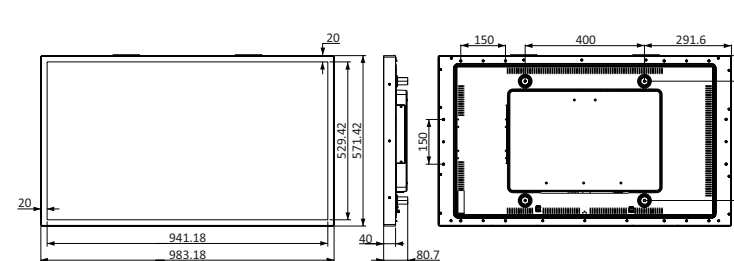
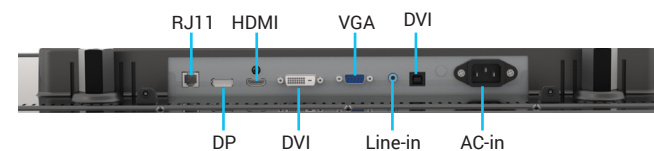

TDS-55-IGR

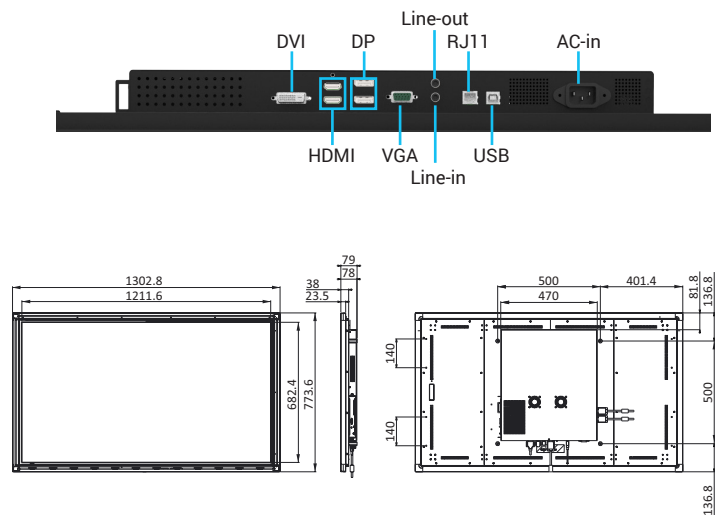

TDS-55

